

# NEW CARRADICE QUICK-CLIP PANNIER HOOK SYSTEM

## ASSEMBLING THE QUICK-CLIP COMPONENTS TO THE BAG

FIG 1: Slide Quick-Clip hooks (a) and cam (b) onto the aluminium channel (c) fit endstops (f)

FIG 1 & 2: The antiway arm (d) adjusts using 4mm allen key it can be reversed by swivelling 180 degrees

FIG 2: Ensure that the quick-clip cam (b) sits approx on the center of the channel

FIG 3: Use reducers (e) to fit 8 to 11mm pannier racks  
2 x 8mm and 2 x 11mm provided.

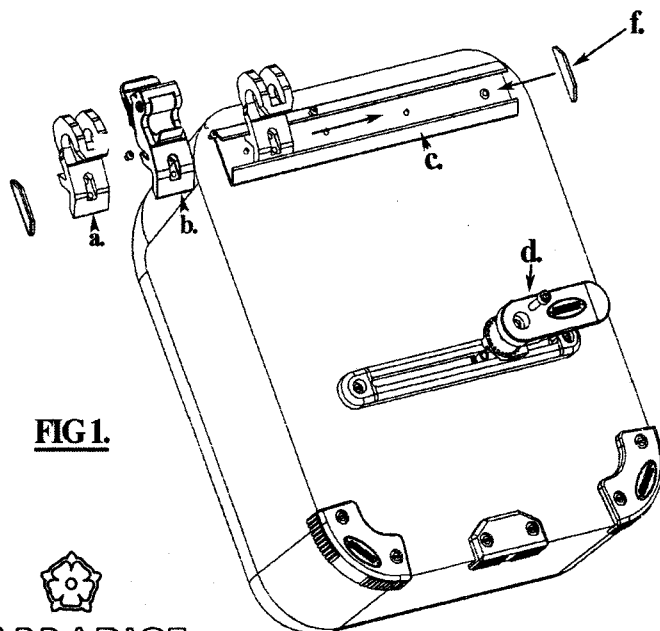

**FIG 1.**

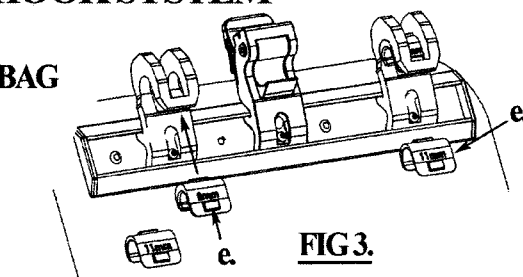

**FIG 3.**

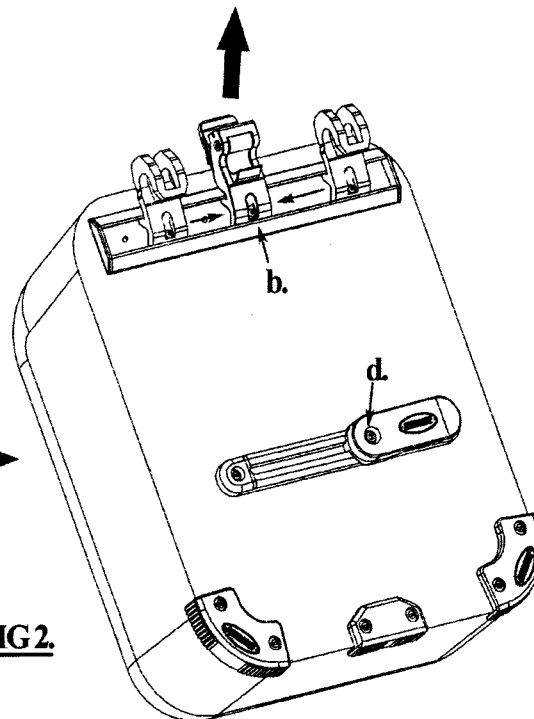

**FIG 2.**

CARRADICE

## INSTALLING THE QUICK-CLIP PANNIER TO THE RACK

STEP 1: Hook the pannier (1) onto the carrier rails (2) and position so that the hooks (3) are free from obstruction and the anti-way catch (4) locates behind a carrier stay (5)

STEP 2: Position the hooks (3) so that the pannier cannot slide backwards along the carrier (The anti-way catch (4) should prevent it from sliding forwards)

Once in position, secure the hooks with the screws provided (one per hook) and tighten the screw to secure the anti sway catch.

STEP 3: To Mount the pannier bag (1) first locate the antiway catch (4) behind the carrier stay (5) then slide the bag down until the hooks (3) and csystem (6) locate and lock on the bar.

STEP 4: To remove the pannier press the red Quick-Clip cam (6) towards the rack and pull upwards.

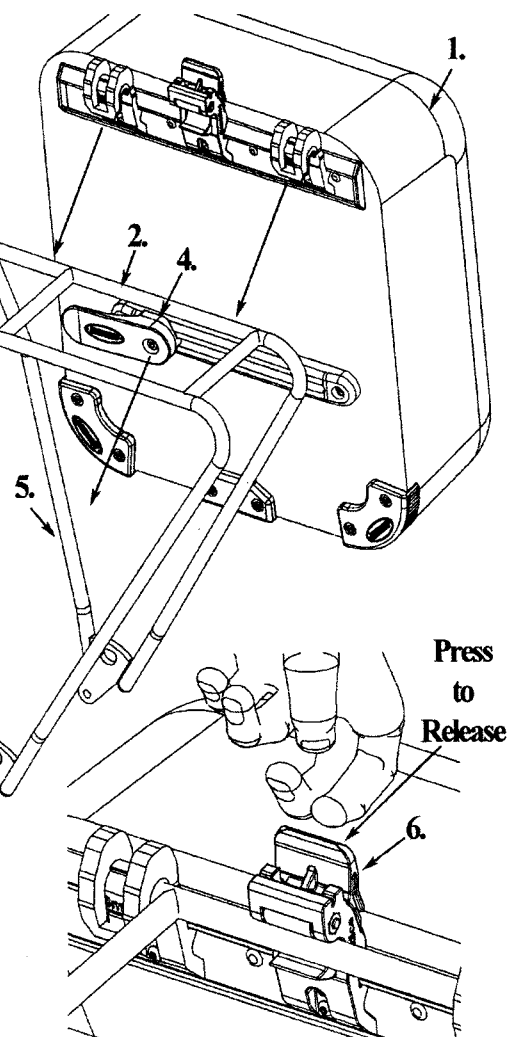
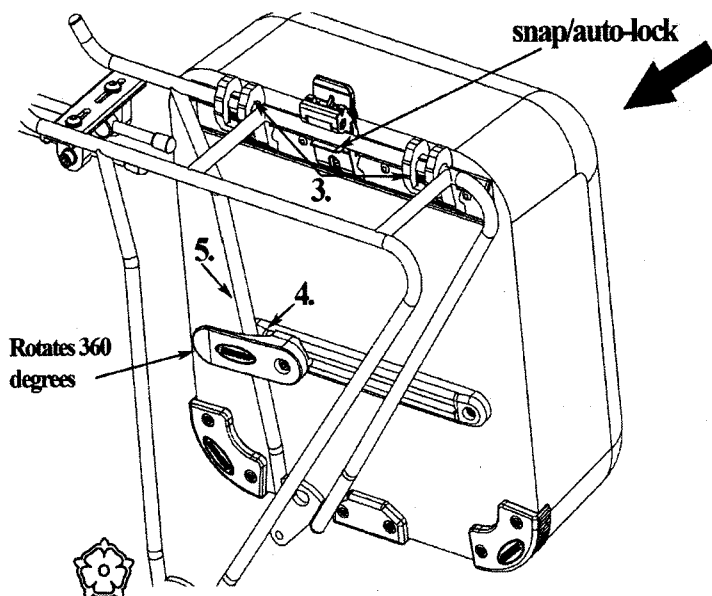

CARRADICE