

DEORE XT Rapidfire Plus Lever

SL-M780 Rapidfire Plus Lever

SM-SL78-B I-spec Bracket (B-type)

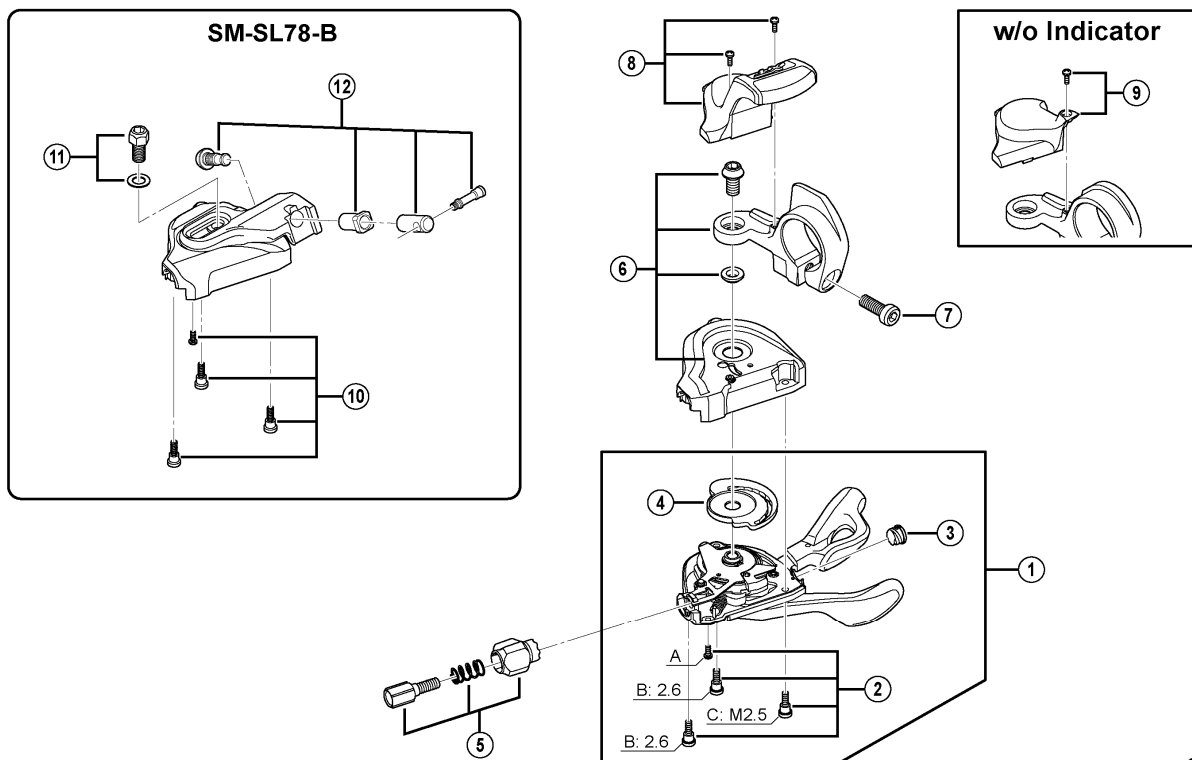

SL-M980

SL-M780-B-I

ITEM NO.	SHIMANO CODE NO.	DESCRIPTION	INTERCHANGEABILITY		
1	Y6UU98030	R.H. Shifting Lever Unit			
	Y6UV98030	L.H. Shifting Lever Unit			
2	Y6UU98040	Base Cover Fixing Screw Unit			
3	Y6CD33000	Inner Hole Cap	A	A	
4	Y6UU11000	R.H. Pin Plate			
	Y6UV61000	L.H. Pin Plate			
5	Y6TA98020	R.H. Cable Adjusting Bolt Unit	B	A	
	Y6UV98020	L.H. Cable Adjusting Bolt Unit	B	A	
6	Y6UU98050	R.H. Base Cover Unit for w/ Indicator Type			
	Y6UU98060	R.H. Base Cover Unit for w/o Indicator Type			
	Y6UV98040	L.H. Base Cover Unit for w/ Indicator Type			
	Y6UV98050	L.H. Base Cover Unit for w/o Indicator Type			
7	Y6T842000	Clamp Bolt (M5 x 13.5)	A		
8	Y6UU98070	R.H. Indicator Unit			
	Y6UV98060	L.H. Indicator Unit			
9	Y6UU98090	R.H. Base Cap & Bolt			
	Y6UV98080	L.H. Base Cap & Bolt			
10	Y6T798020	Shifting Lever Fixing Screw Unit for SM-SL78-B	A	A	
11	Y6T798050	Unit Fixing Bolt (M5 x 9.5) & Washer for SM-SL78-B	A	A	
* 12	Y6UV98090	Bolt & Nut Unit for SM-SL78-B			A

A: Same parts.

B: Parts are usable, but differ in materials, appearance, finish, size, etc.

Absence of mark indicates non-interchangeability.

Mar.-2013-3183A

© Shimano Inc. A

Specifications are subject to change without notice.

SHIMANO