

Steel forks for auto connected hub dynamos SONdelux SL / SON 28 SL require a recess on the right dropout (diameter 24 x 1 mm) with three drillings (diameter 3 mm) in order to take up the insulating plate. The left dropout, for ground contact, remains plain and not insulated but needs to be corrosion resistant. It could be made up of stainless steel, otherwise a standard steel dropout will be protected either with a stainless steel plate (welded on or soldered) or by chrome plating. You can make a corrosion-free ground contact at the fork crown by soldering a cone plate (Part no. 73250).

The custom-made SL fork demands appropriate dropouts, either laser cut, forged or machined investment castings. Several types of laser cut stainless steel dropouts can be delivered. A wider range of shapes such as investment cast dropouts, drilled and machined dropouts as well as dropouts of mild steel are available on request.

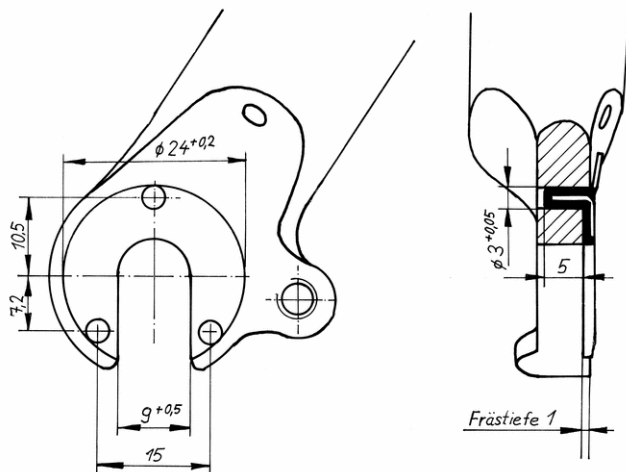

Dropout on right side

Modification of prefabricated forks with conventional dropouts is hardly possible, as steel dropouts are generally too thin to place the contact parts.



Set of contact parts with 500 mm wire, cable exit at 45°

Sets of contacts parts with insulating plate and contact plate with soldered wire are available with cable exit at the contact plate in different angles.